

# Yealink | 亿联网络

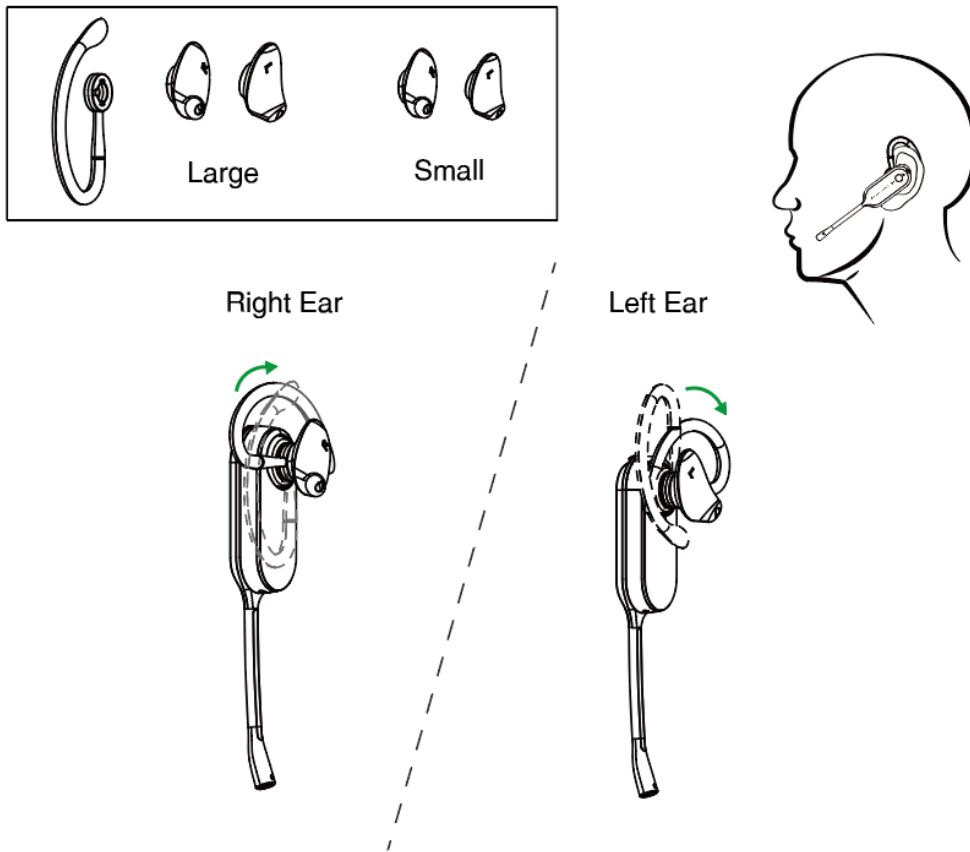

## WH6X Wireless Headset User Guide

- Earhook & Eartip wearing style: enhance wearing stability



- Headband wearing style: comfortable to wear  
The headset can be worn with the microphone on the left or the right.



- Neckband wearing style: preserve your hairstyle

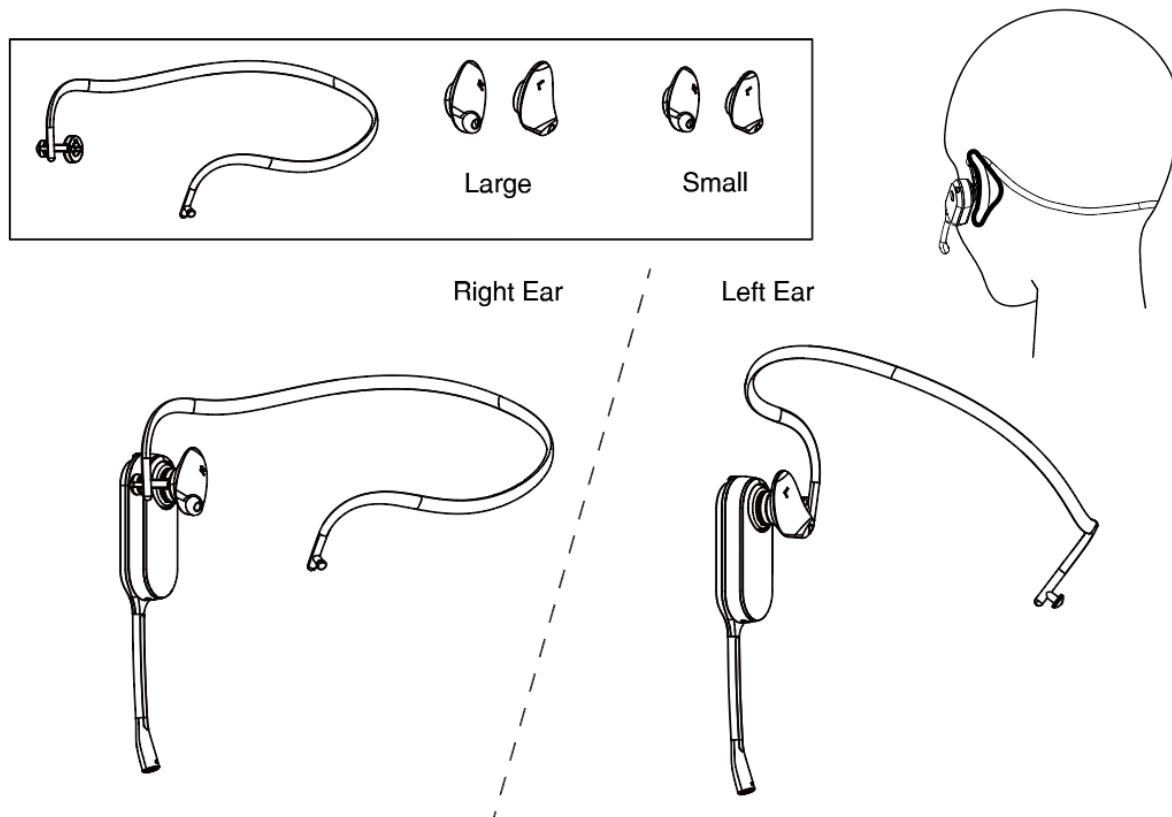

## Remove the Pre-installed Eartip from the Headset

When you need to change the wearing styles, you can do the following:

1. Gently pull the eartip from the headset.

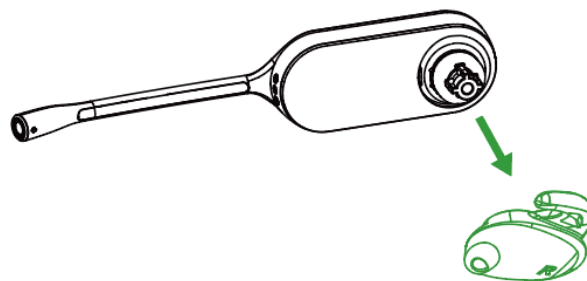

- 📄 **Note:** To wear the headset on the right ear but with a different size eartip or wear the headset on the left, select the size you want and reinstall in reverse order as shown.

## Earhook & Eartip Assembly

The headset can be assembled for wearing on the left or right ear.

- 📄 **Note:** Before installing the earhook & eartip, remove the pre-installed eartip from the headset.

**For Right ear:**

1. Align the earhook (🔌 port) as shown and insert it onto the headset. Be sure the earhook is flat against the headset and rotate the earhook up 90°.

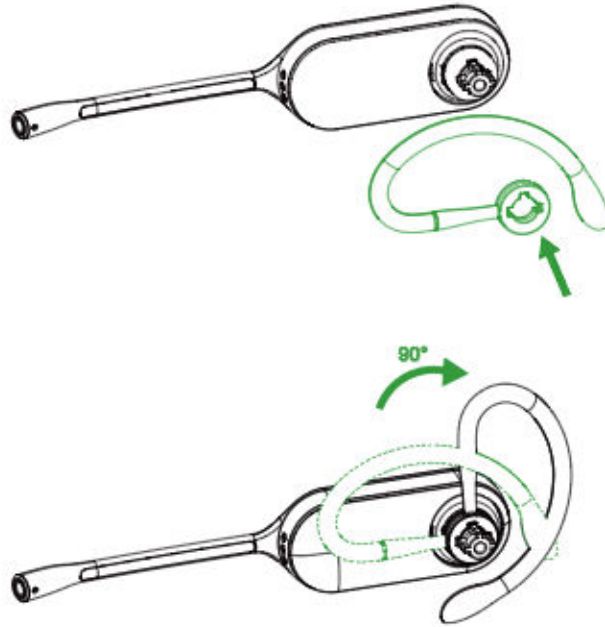

2. Choose the size of eartip that fits most comfortably. Align the eartip with the notch facing the microphone as shown. Press on to attach.

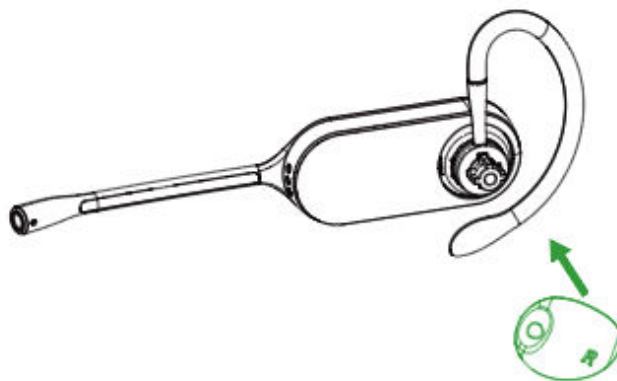

The earhook is flexible, and can be bent to suit your ear for a secure and comfortable fit.

**For left ear:**

The difference between the right ear and the left ear assembly is that the direction of the earhook is different.

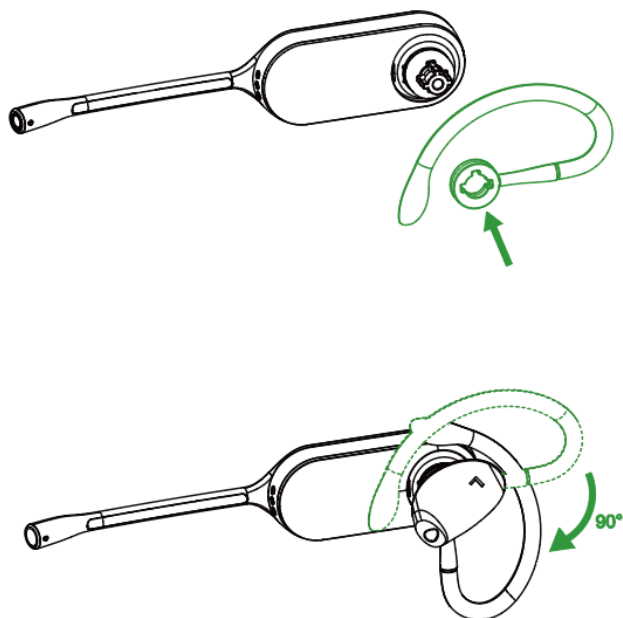

**Related information**

[Remove the Pre-installed Eartip from the Headset](#)

**Headband Assembly**

The headset can be rotated for wearing on the left or right ear.

 **Note:** Before installing the headband, remove the pre-installed eartip from the headset.

**For Right ear:**

1. Hold the headband, so it is aligned to receive the headset as shown and insert the headset into the headband.

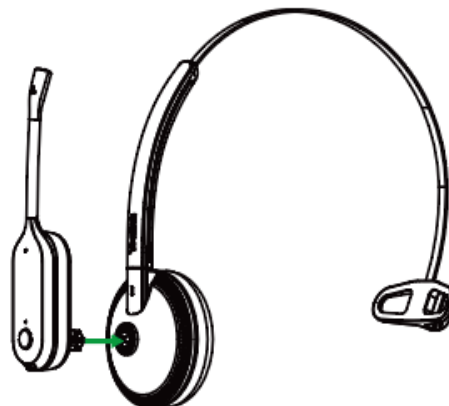

2. Rotate the headset down.



3. To optimize the position of the headset, push the headset in so the microphone is close to the corner of your mouth.



**Note:** The headband is adjustable, and can be adjusted to the most comfortable fit.

**For Left ear:**



### Related information

[Remove the Pre-installed Eartip from the Headset](#)

## Neckband Assembly

The headset can be assembled for wearing on the left or right ear.

 **Note:** Before installing the neckband, remove the pre-installed eartip from the headset.

### For Right ear:

1. Align the short shot ( port) as shown and insert it onto the headset.

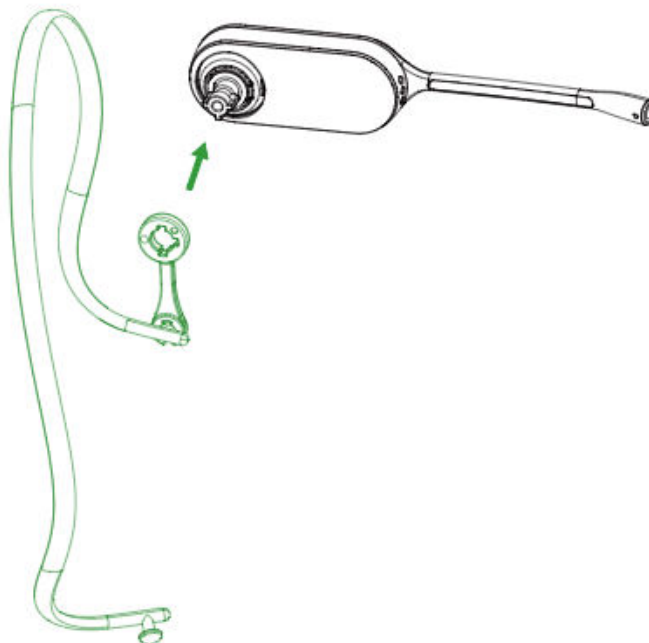

2. Choose the size of eartip that fits most comfortably. Align the eartip with the notch facing the microphone as shown. Press on to attach.

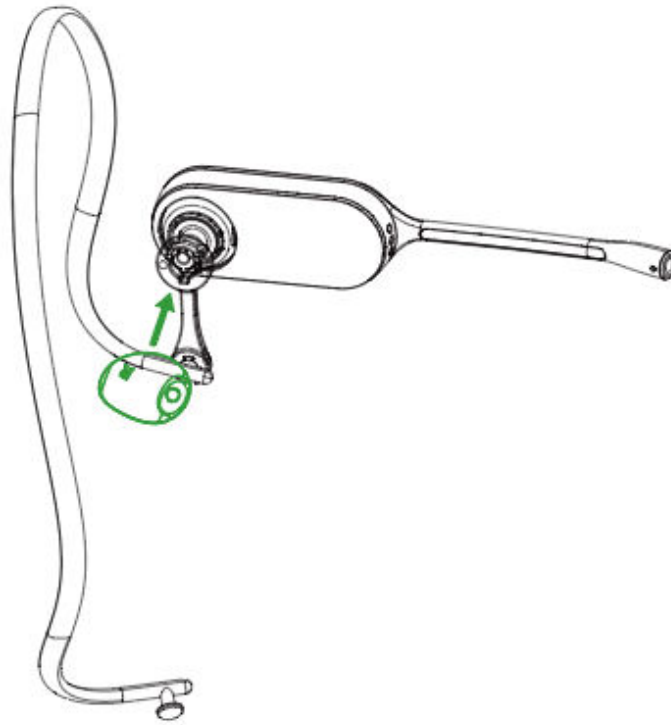

**For Left ear:**

1. Remove the pre-installed connecting rod.

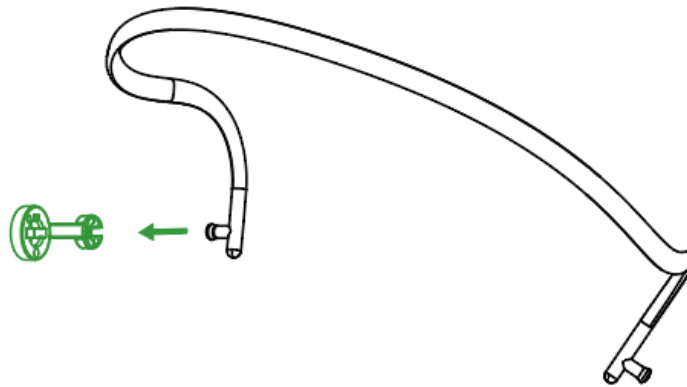



2. Install the connecting rod to the other end of the neckband.

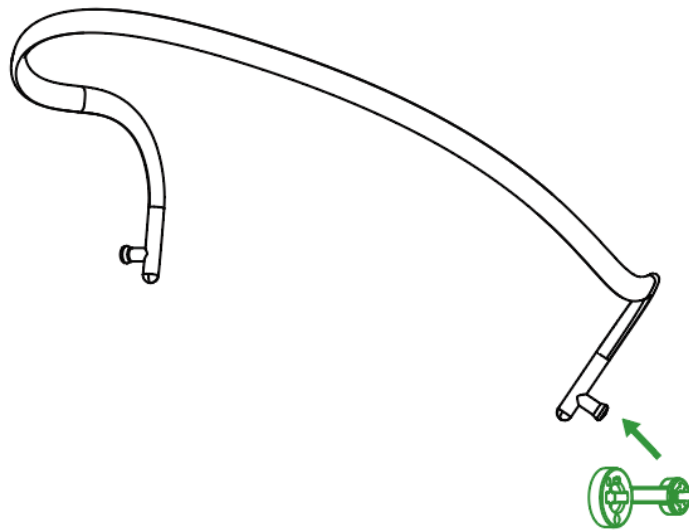

3. Align the short shot (  port) as shown and insert it onto the headset.

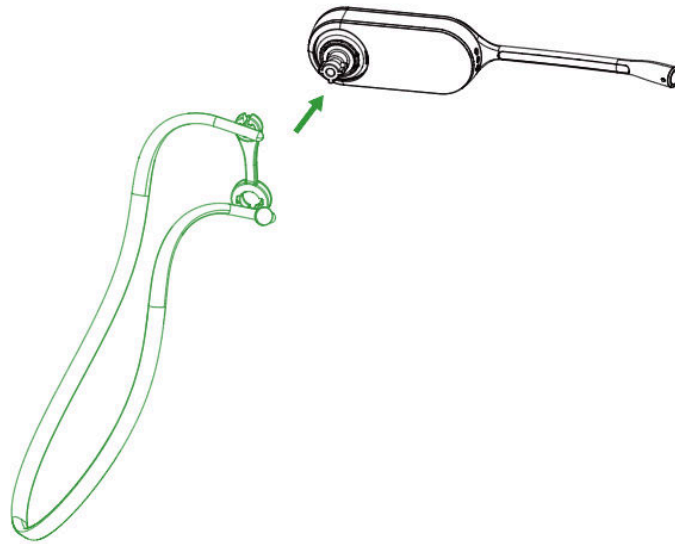

4. Choose the size of eartip that fits most comfortably. Align the eartip with the notch facing the microphone as shown. Press on to attach.